

This drawing has been prepared for the use of the client. It may not be used, modified, reproduced or distributed without the prior written consent of the client. The client is responsible for ensuring that the drawing is used for the intended purpose and that all necessary permissions have been obtained from the relevant authorities.

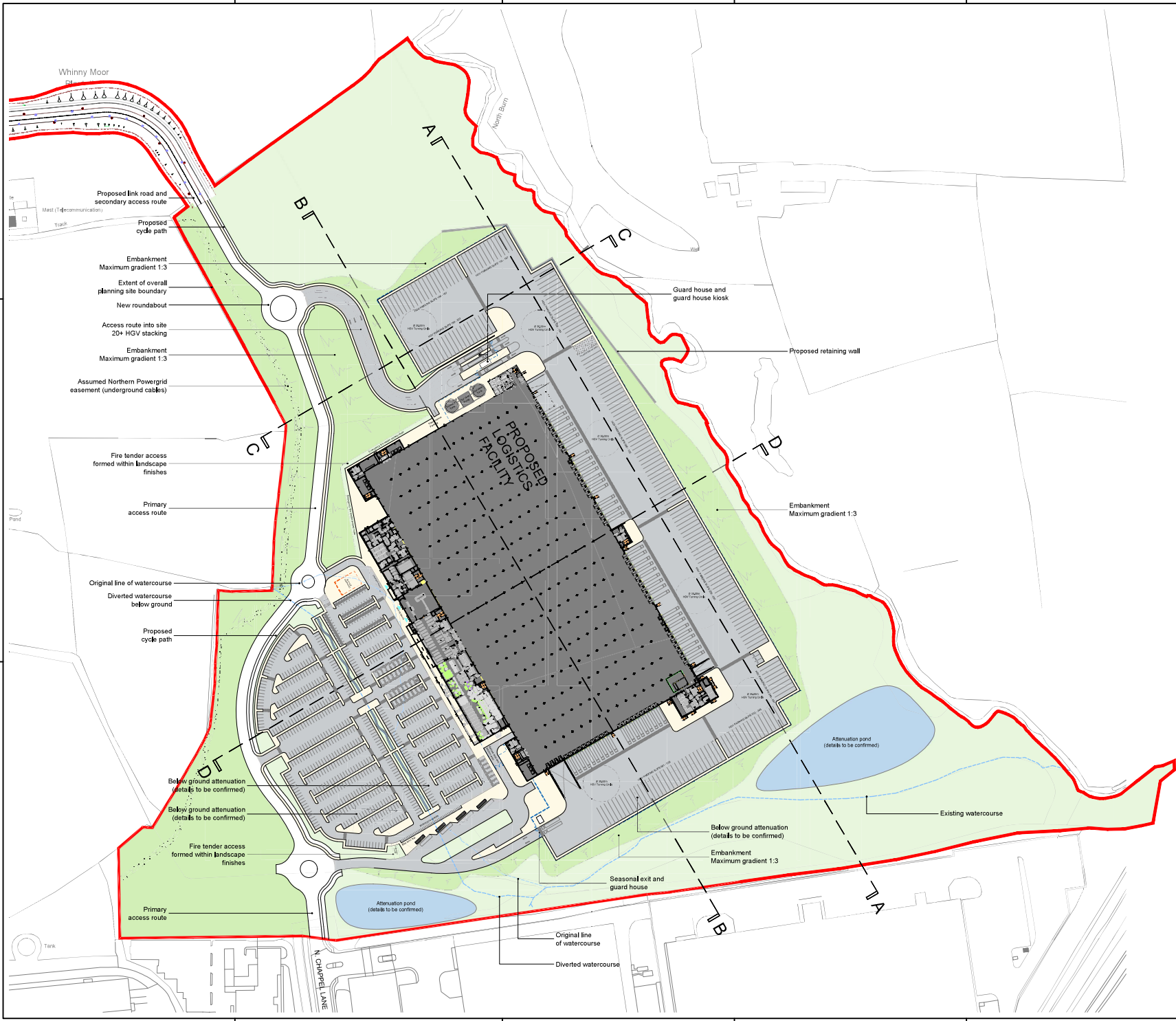

KEY FACTS	
SCHEDULE	PROPOSED
Site Area	33.7 ha
Truck Queues	20+
Total Dock Doors	64
Truck Spaces	207
Car Parking (Total incl. Disabled)	791
Assembly Car Parking	36
Electric Vehicle Parking	60
Motorbike Parking	41
Cycle Spaces	80
Shunter Spaces	3

UNIT AREA SCHEDULE		
	GIA (m <sup>2</sup> )	GIA (ft <sup>2</sup> )
P1 GROUND FLOOR	62,268 m <sup>2</sup>	669,893 ft <sup>2</sup>
P2 FIRST FLOOR	45,346 m <sup>2</sup>	488,100 ft <sup>2</sup>
P3 SECOND FLOOR	45,346 m <sup>2</sup>	488,100 ft <sup>2</sup>
P4 THIRD FLOOR	45,346 m <sup>2</sup>	488,100 ft <sup>2</sup>
ROOF ACCESS	190 m <sup>2</sup>	2,045 ft <sup>2</sup>
TOTAL GIA	187,036 m <sup>2</sup>	2,013,238 ft <sup>2</sup>

ANCILLARY BUILDINGS AREA SCHEDULE		
	m <sup>2</sup>	ft <sup>2</sup>
MAIN GUARDHOUSE	28 m <sup>2</sup>	301 ft <sup>2</sup>
SECONDARY GUARDHOUSE	3 m <sup>2</sup>	32 ft <sup>2</sup>
SEASONAL GUARDSHACK	18 m <sup>2</sup>	194 ft <sup>2</sup>

Code	Description	Start	End	Start	End
P1	Proposed system boundary extent and site area	01/01/2024	31/12/2024	01/01/2024	31/12/2024
P2	Proposed site area	01/01/2024	31/12/2024	01/01/2024	31/12/2024
P3	Proposed site area	01/01/2024	31/12/2024	01/01/2024	31/12/2024
P4	Proposed site area	01/01/2024	31/12/2024	01/01/2024	31/12/2024
P5	Proposed site area	01/01/2024	31/12/2024	01/01/2024	31/12/2024
P6	Proposed site area	01/01/2024	31/12/2024	01/01/2024	31/12/2024
P7	Proposed site area	01/01/2024	31/12/2024	01/01/2024	31/12/2024
P8	Proposed site area	01/01/2024	31/12/2024	01/01/2024	31/12/2024
P9	Proposed site area	01/01/2024	31/12/2024	01/01/2024	31/12/2024
P10	Proposed site area	01/01/2024	31/12/2024	01/01/2024	31/12/2024

**Client**

Name: \_\_\_\_\_

Address: \_\_\_\_\_

**Designer**

**ARCADIS** Infrastructure

Address: \_\_\_\_\_

City: \_\_\_\_\_

**Project**

Stockton

Address: \_\_\_\_\_

**Revision**

\_\_\_\_\_

\_\_\_\_\_

\_\_\_\_\_

PROPOSED SITE PLAN					
Design	01	01	01	01	14/09/2023
Check	02	02	02	02	14/09/2023
Issue	03	03	03	03	14/09/2023
Approved	04	04	04	04	14/09/2023

Scale: 1:1000  
 Project name: Wareing  
 Project number: STD  
 Drawing number: STC-ARC-SW-XXDR-AR-0002-S2  
 Issue date: 02  
 Issued for information  
 Not to be used for construction  
 Revision: 08